

BEHAN & FOLEY DRAIN DRAINAGE DISTRICT

Sections 21,27-29, 32-34, T.6N., R.12W., City of Wyoming, Kent County, Michigan

Sections 20-21, 28-29, T.6N., R.12W., City of Grandville, Kent County, Michigan

Sections 3-4, T.5N., R.12W., Byron Township, Kent County, Michigan

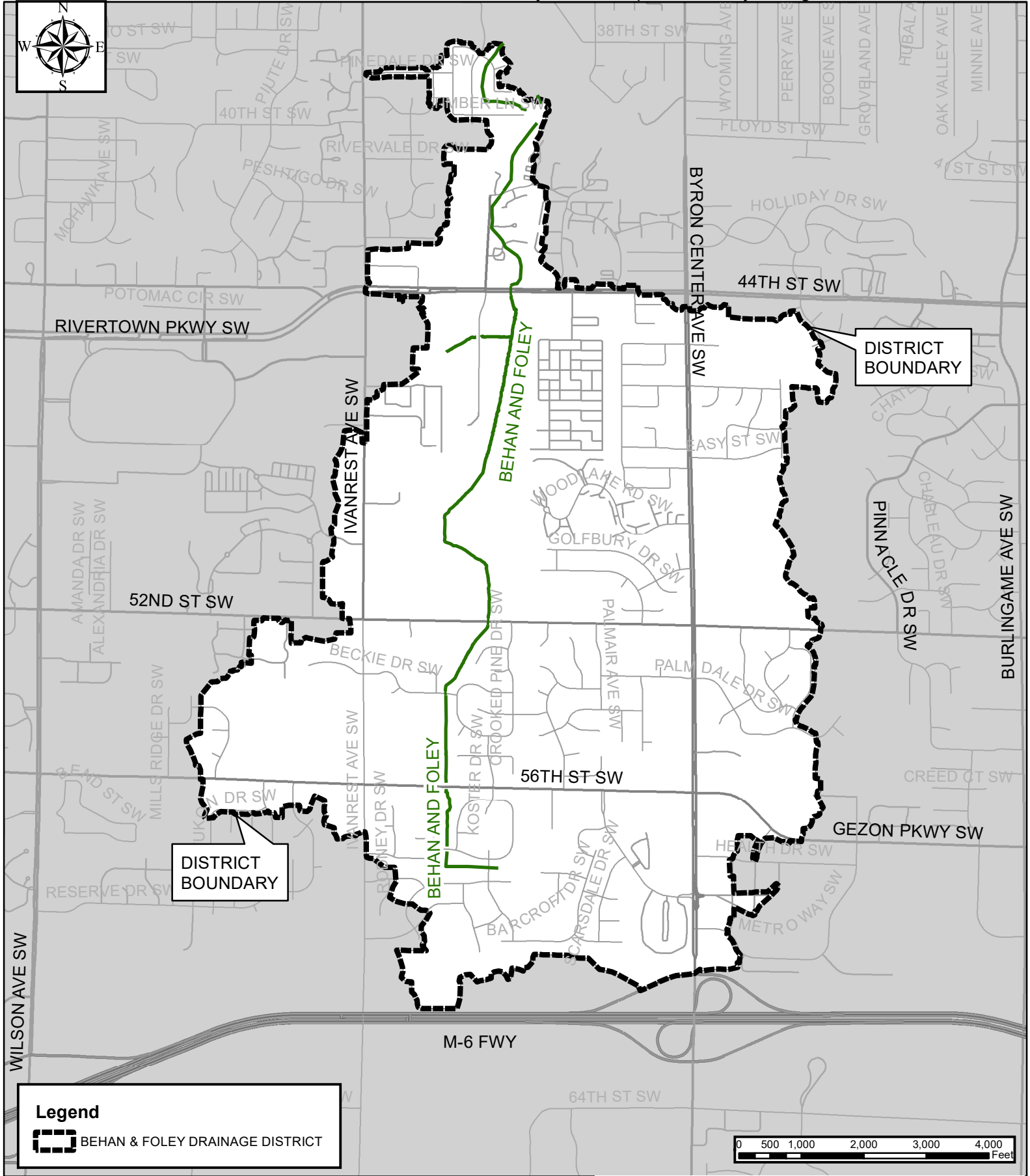

KENNETH YONKER,
KENT COUNTY DRAIN COMMISSIONER

AEL - 6.27.22



Kent County, MI makes no warranty, expressed or implied, regarding the accuracy, completeness or usefulness of information presented. Users of this information assume all liability for its fitness for a particular use.

BEHAN & FOLEY DRAIN DRAINAGE DISTRICT

Sections 21,27-29, 32-34, T.6N., R.12W., City of Wyoming, Kent County, Michigan

Sections 20-21, 28-29, T.6N., R.12W., City of Grandville, Kent County, Michigan

Sections 3-4, T.5N., R.12W., Byron Township, Kent County, Michigan

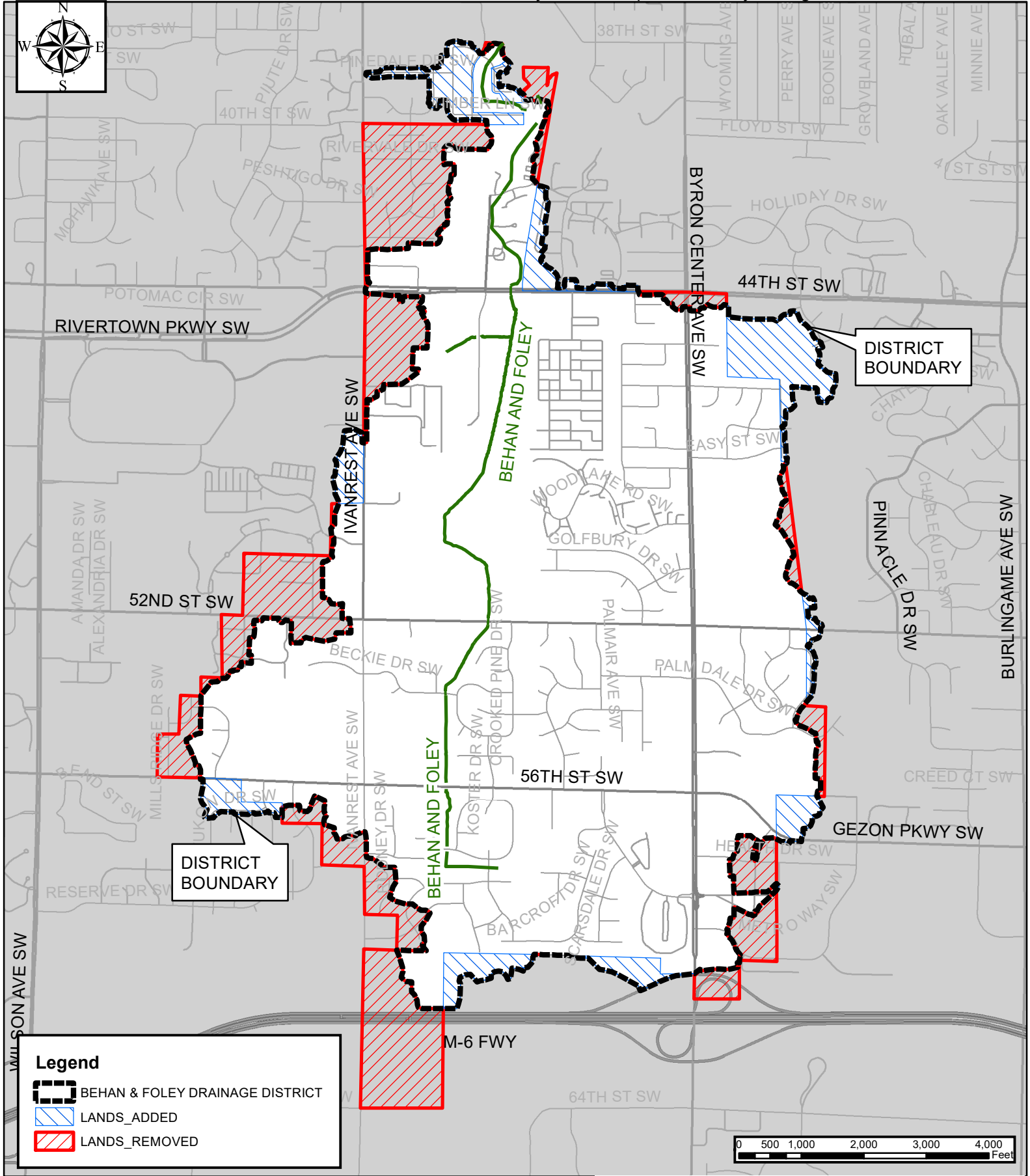

Legend

- BEHAN & FOLEY DRAINAGE DISTRICT
- LANDS_ADDED
- LANDS_REMOVED

KENNETH YONKER,
KENT COUNTY DRAIN COMMISSIONER

AEL - 6.27.22



Kent County, MI makes no warranty, expressed or implied, regarding the accuracy, completeness or usefulness of information presented. Users of this information assume all liability for its fitness for a particular use.